

---

Xibu  
inoxTOWEL

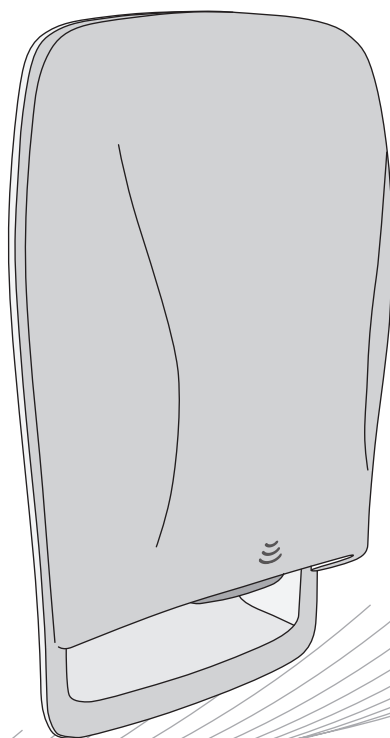

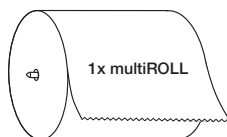
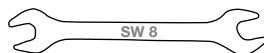
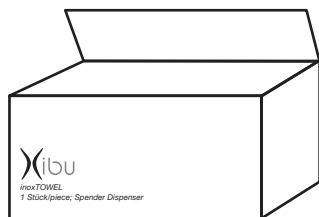

D-Type (mono/LR20)  
ALKALINE

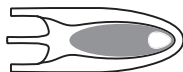

1 x



4 x



1 x



1 x



1 x

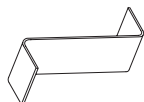

1 x

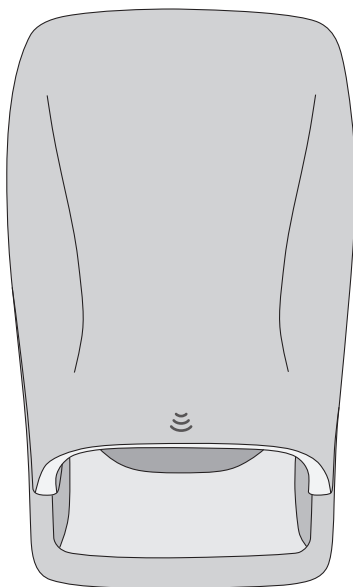

1.

1 x

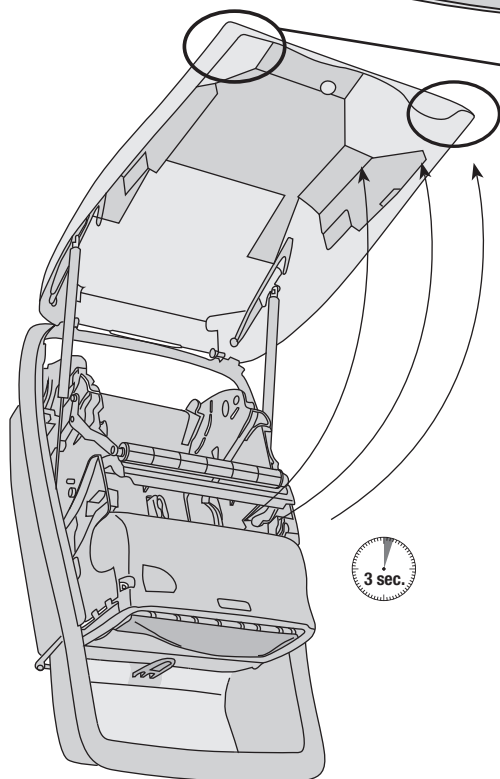
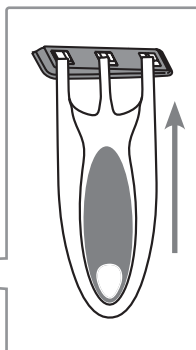
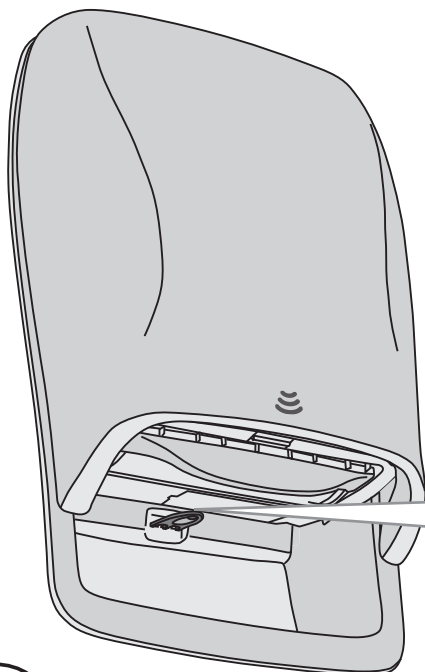
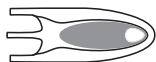

Öffnungskraft  
opening force

$F = 25\text{ N}$

Öffnungsgeschwindigkeit  
opening speed

ca. 3 sec

2.

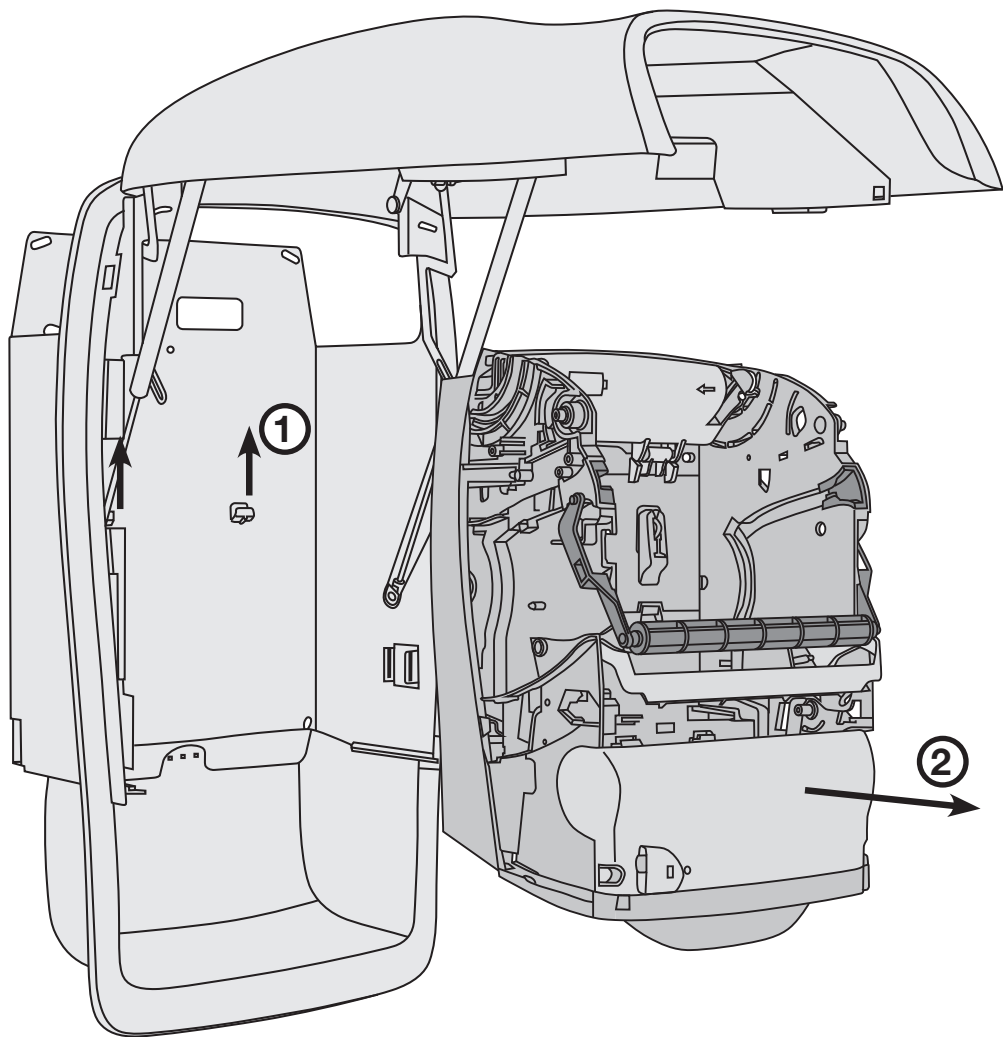
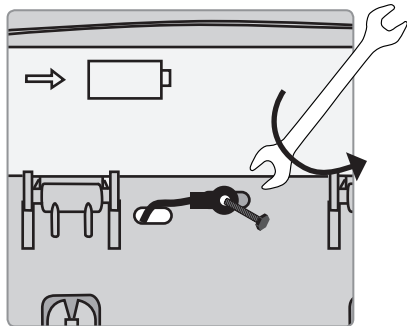

3.

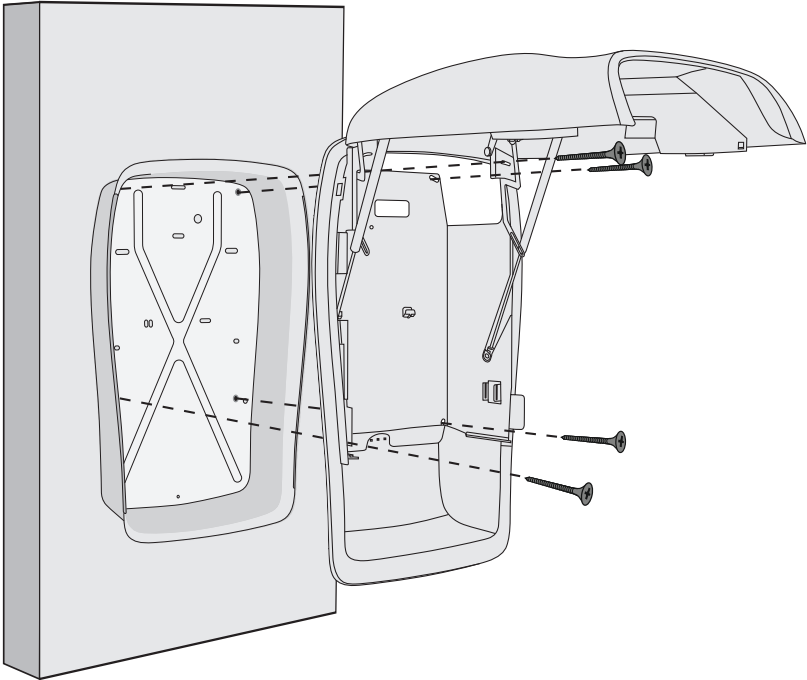
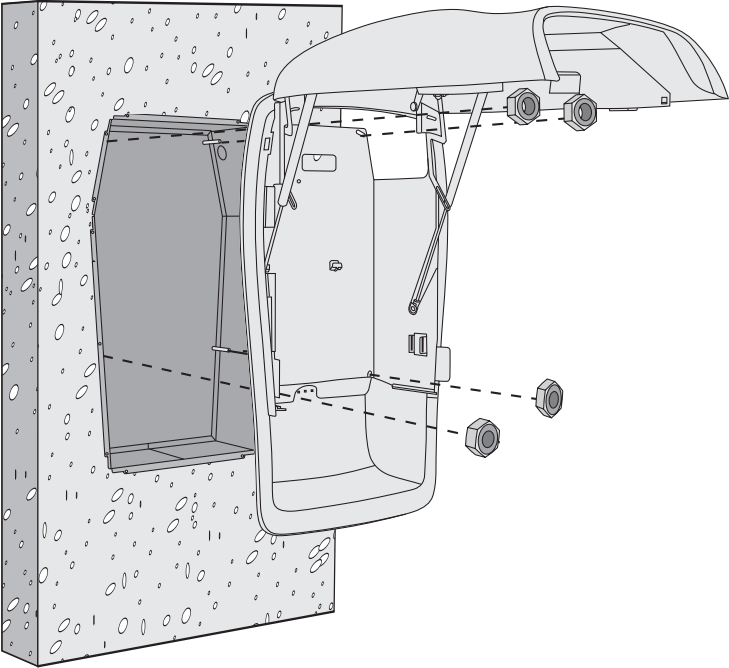

4.

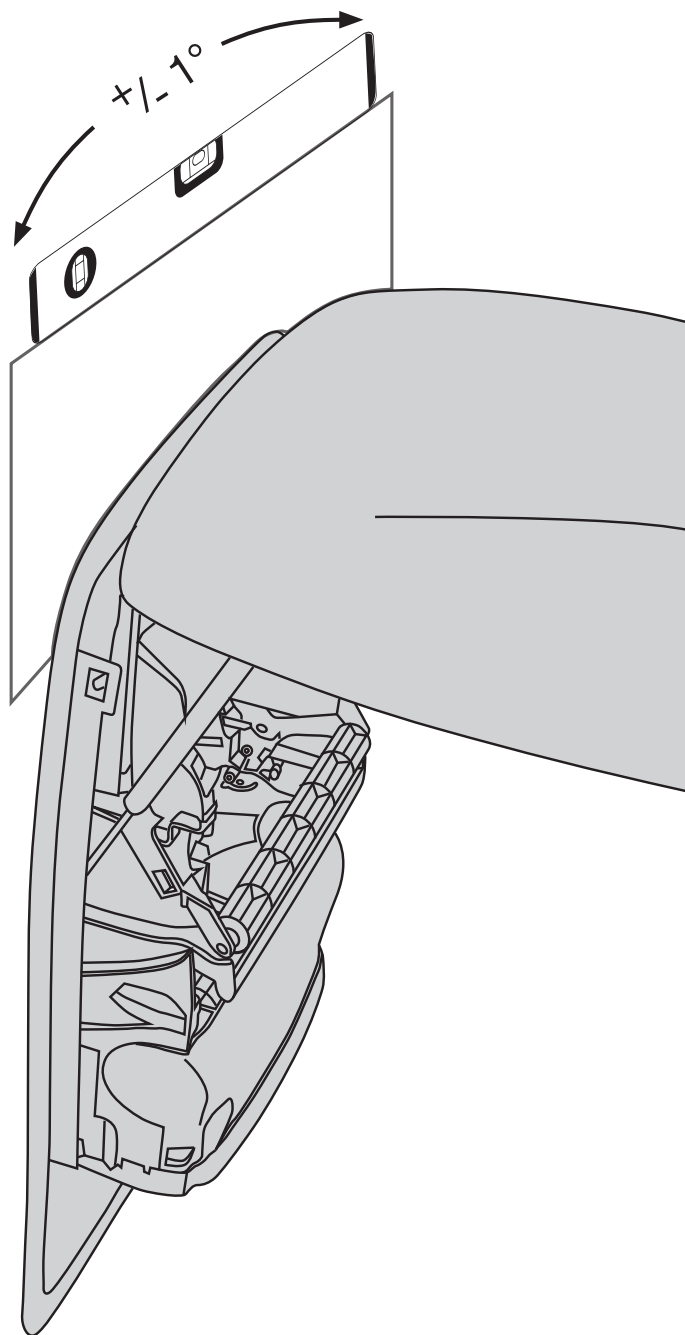

5.

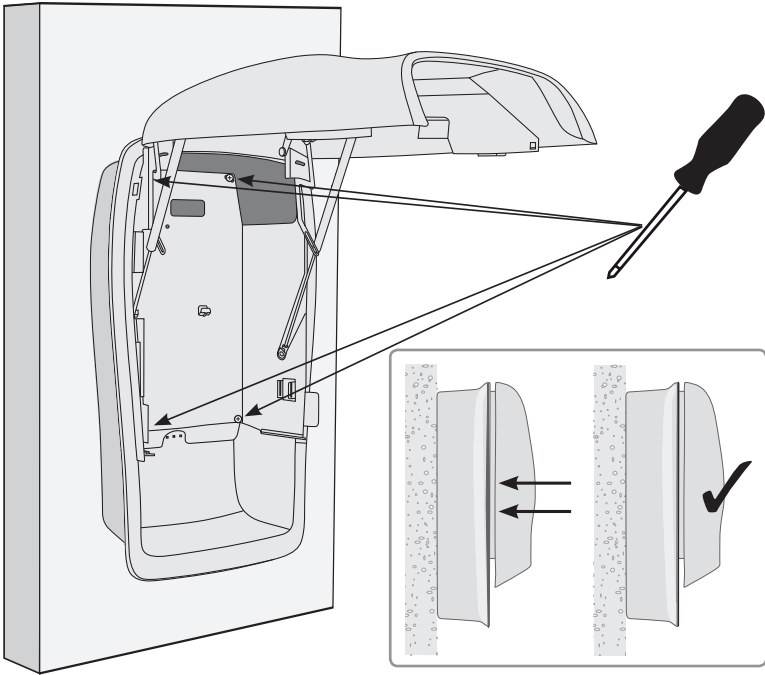
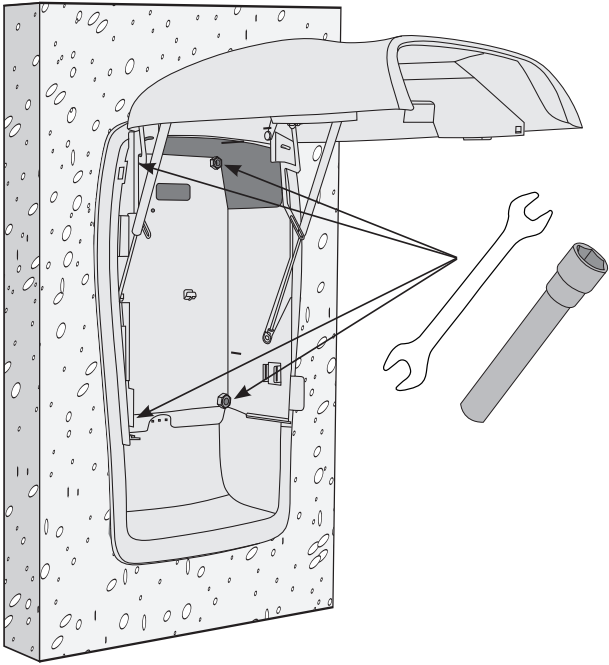

6.

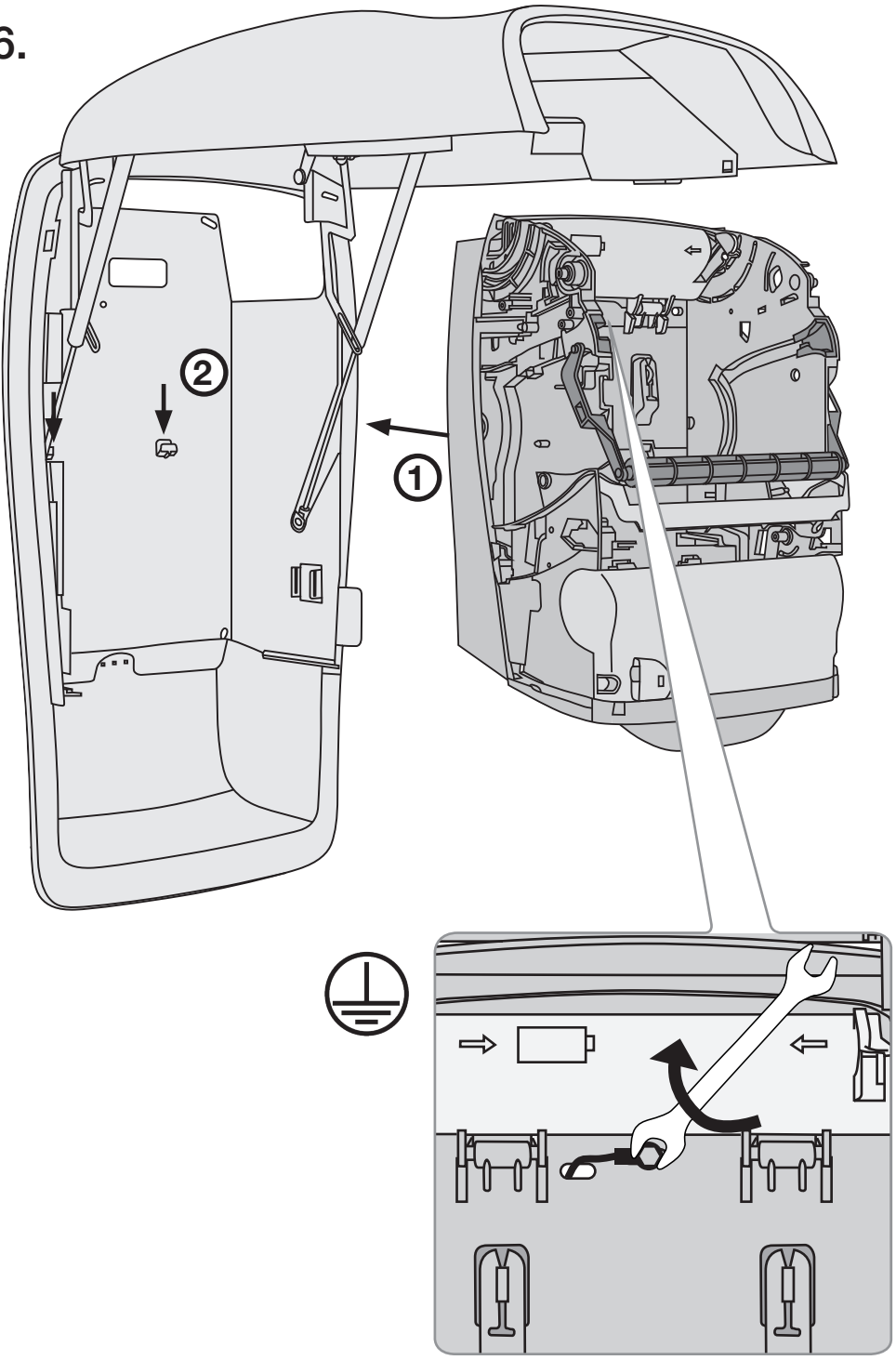



7.

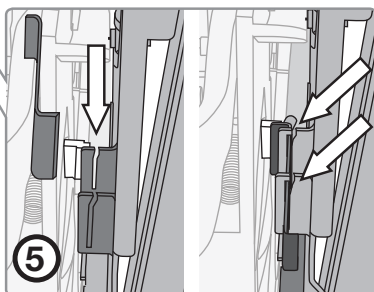
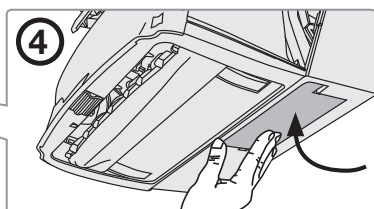
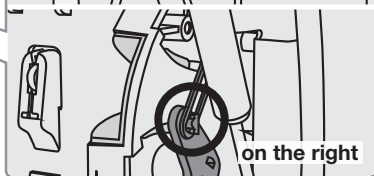
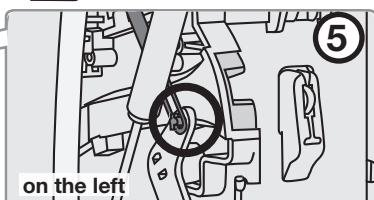
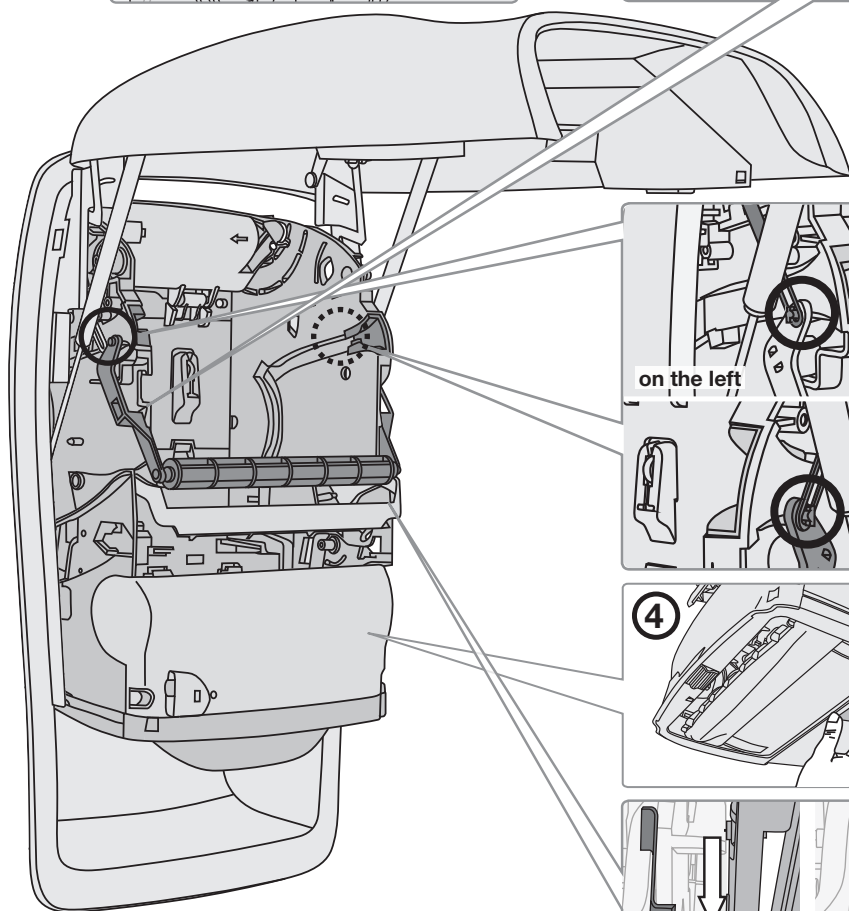
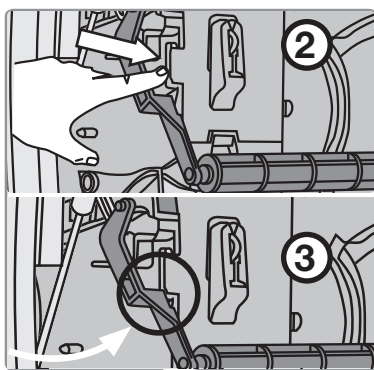
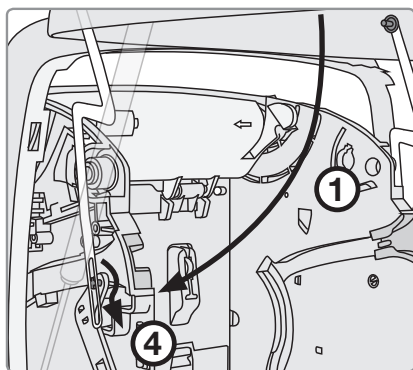

8.

D-Type (mono/LR20)  
ALKALINE

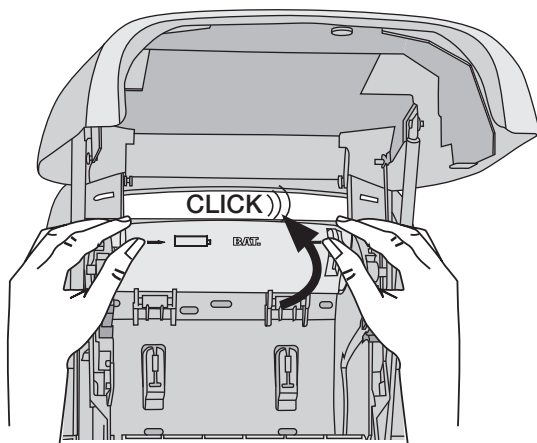
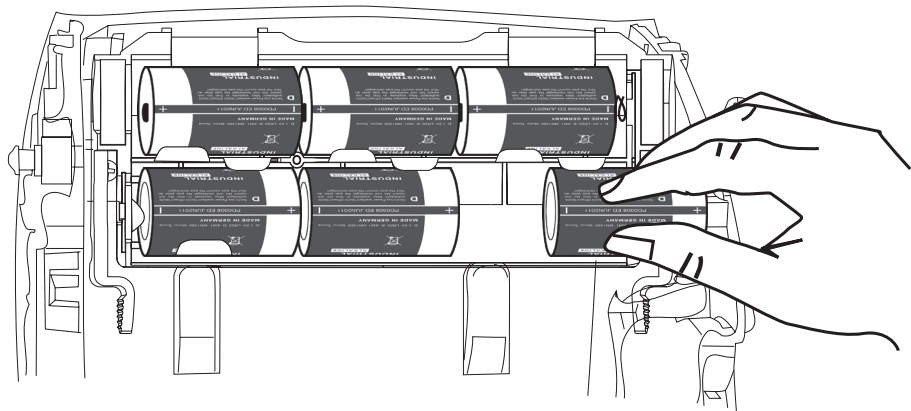
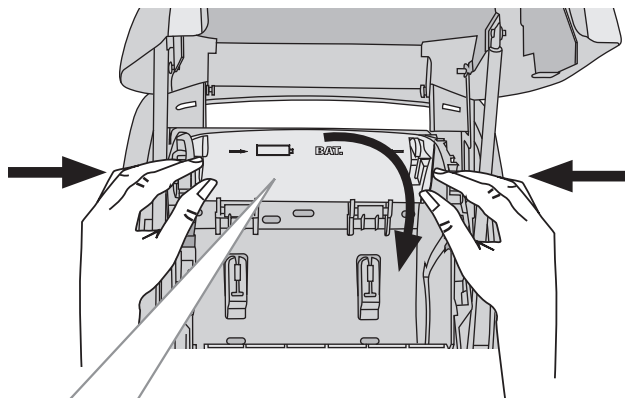

9.

1 x

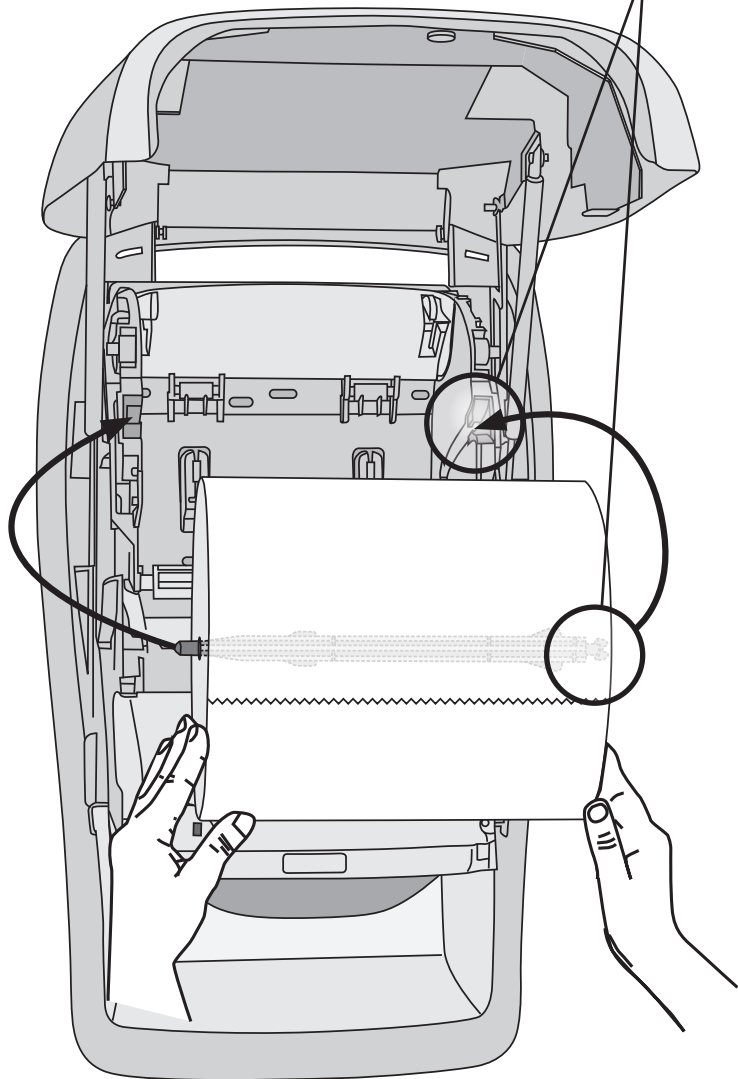
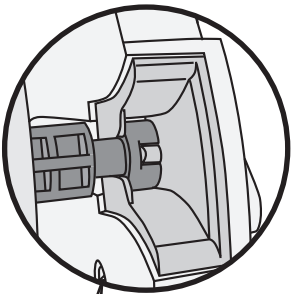
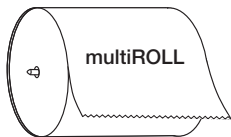

10.

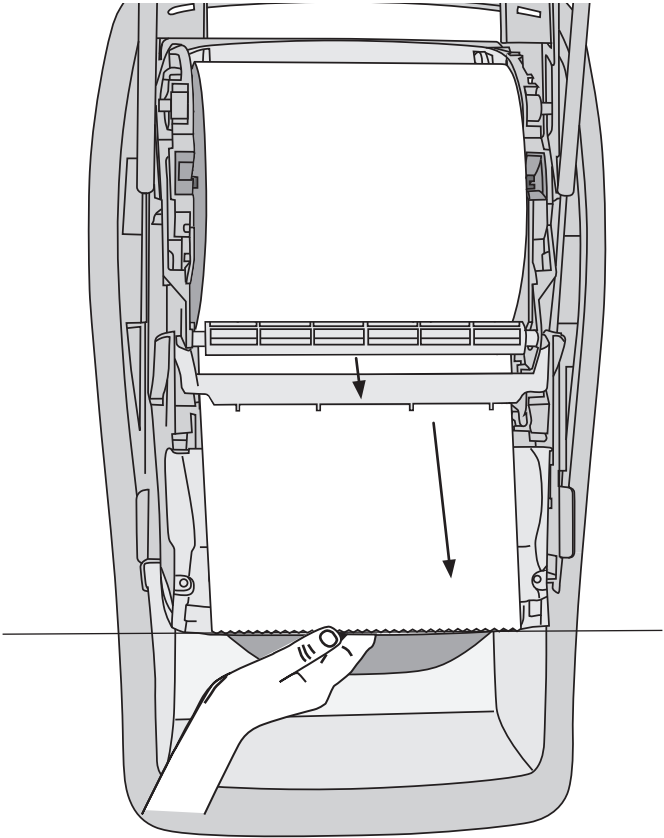

11.

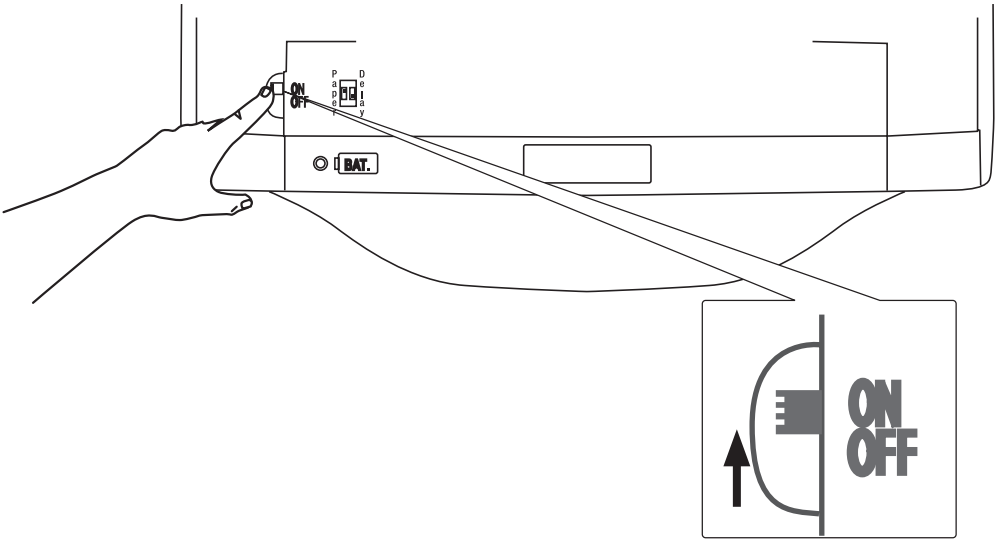

12.

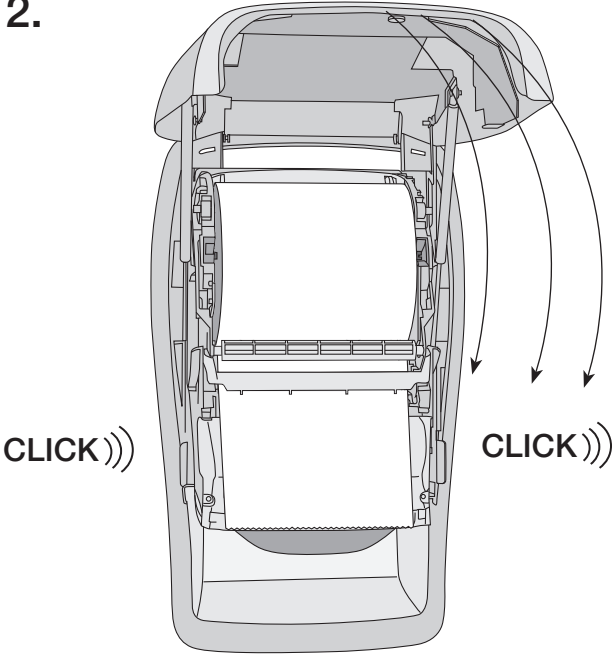

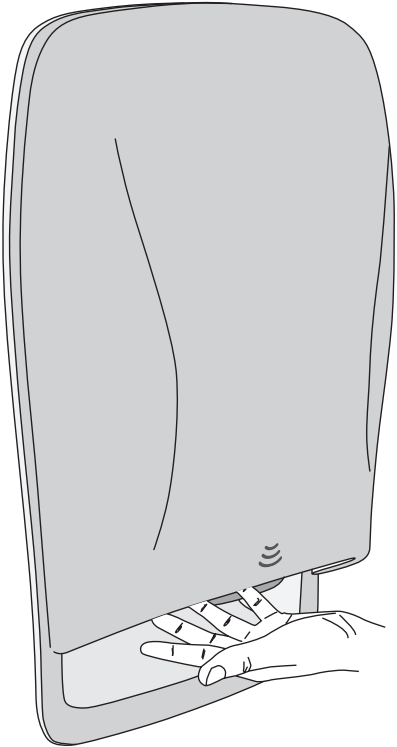

13.



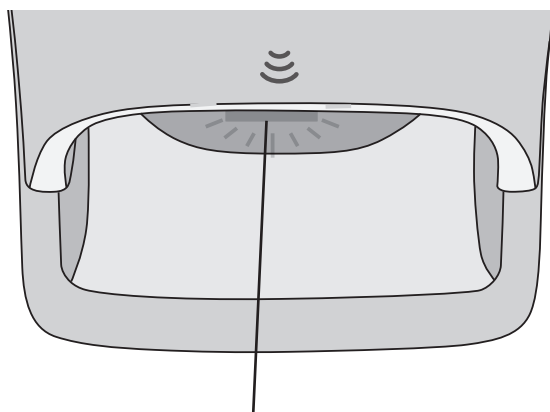
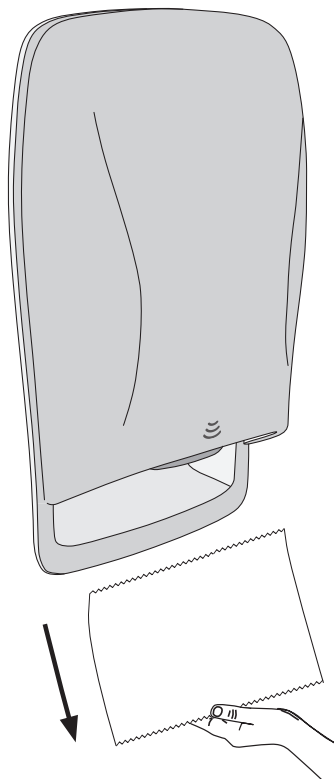

14.



green = ok

green+red = refill  (14.) / change  (4., 7., 11.)

red =  /  empty

15.

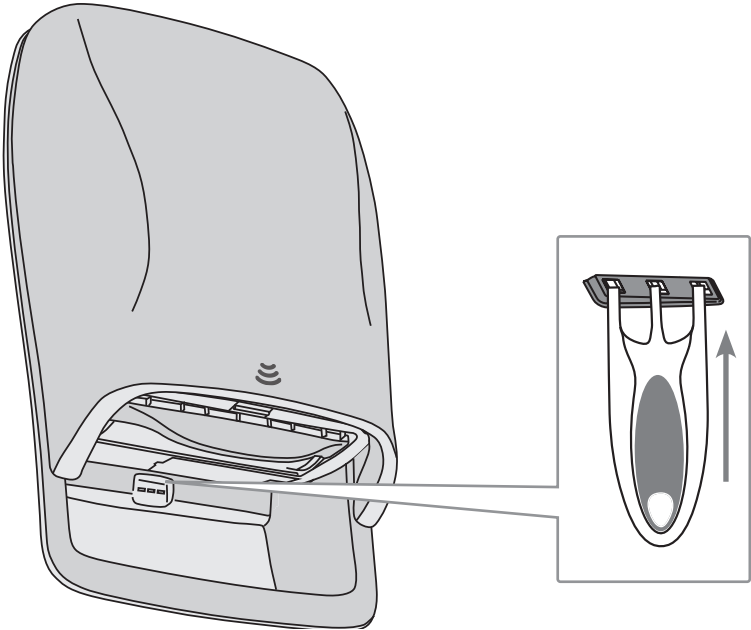

16.

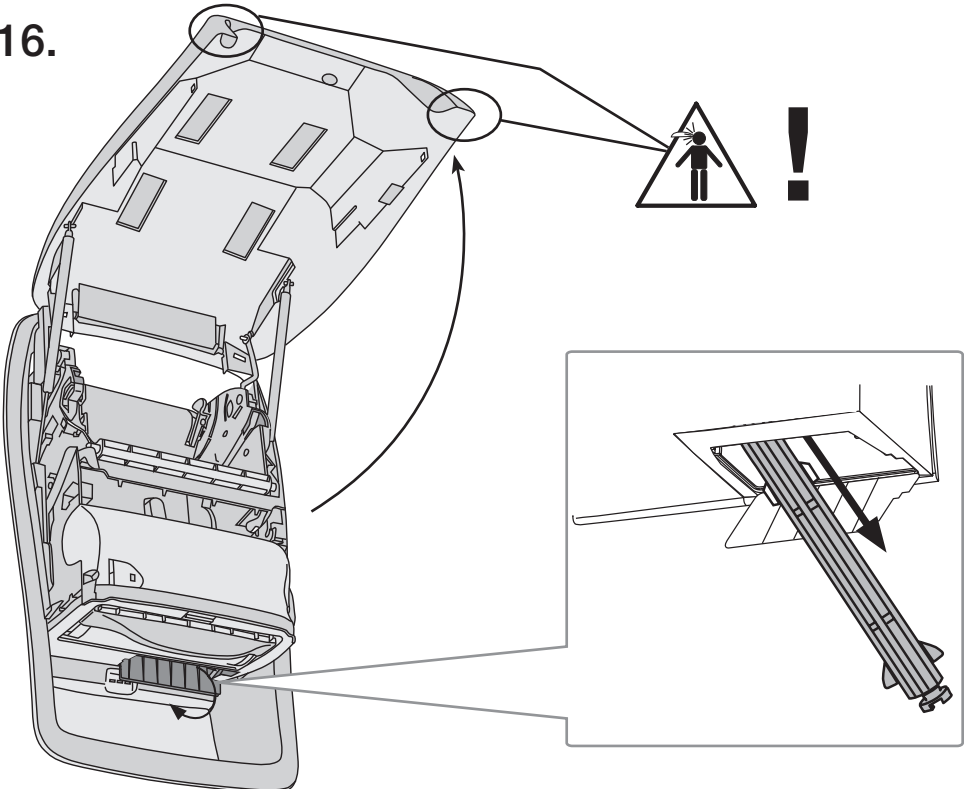

17.

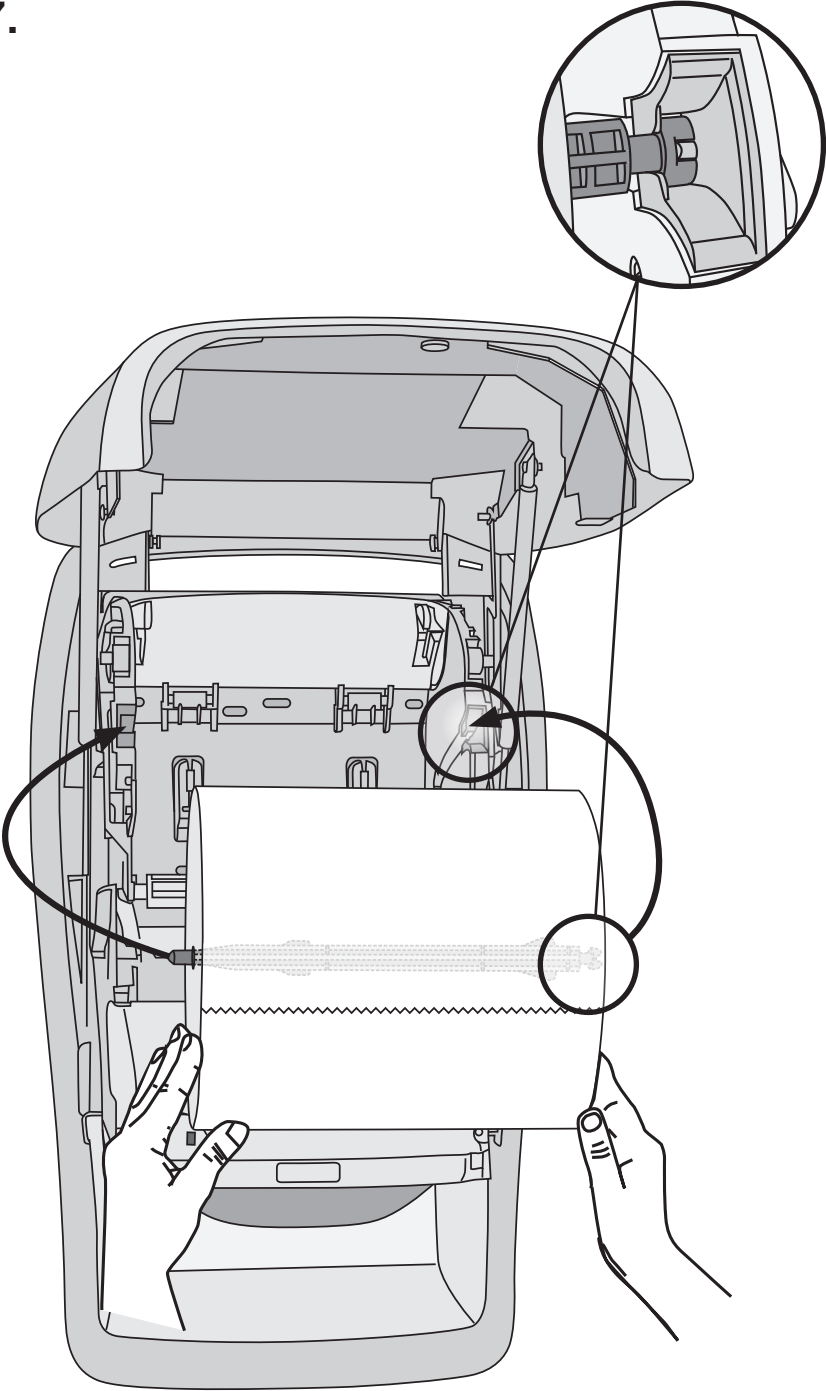



18.

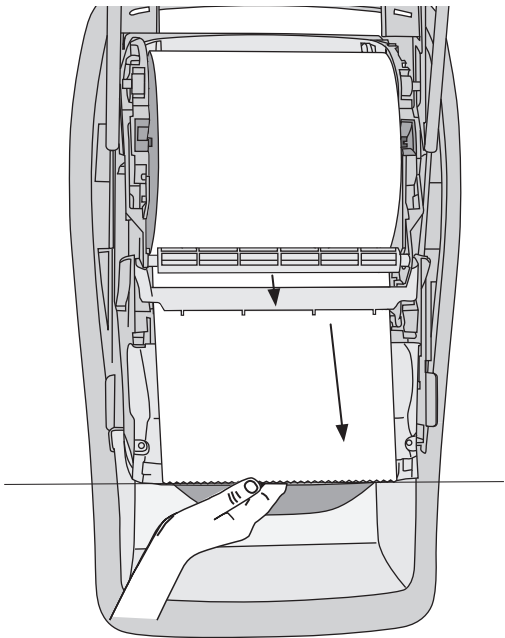

19.

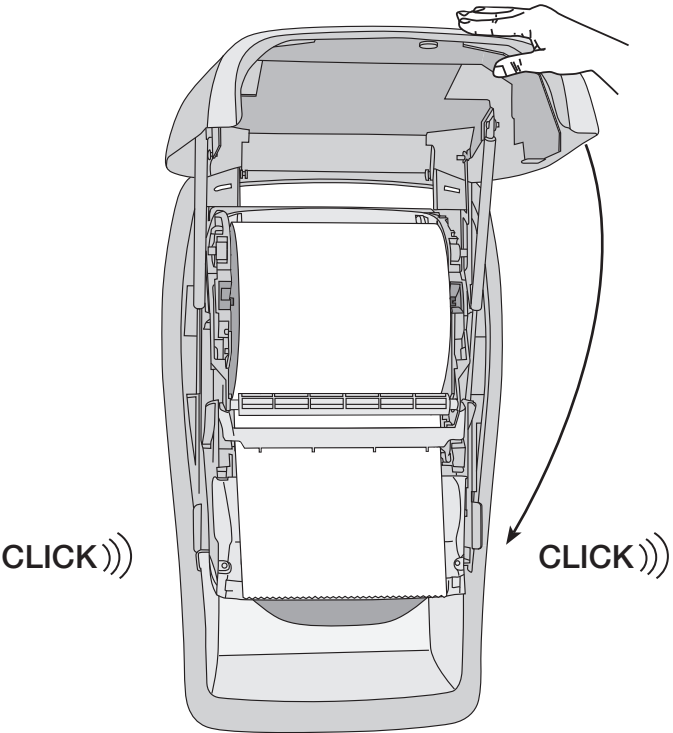

# Functions:

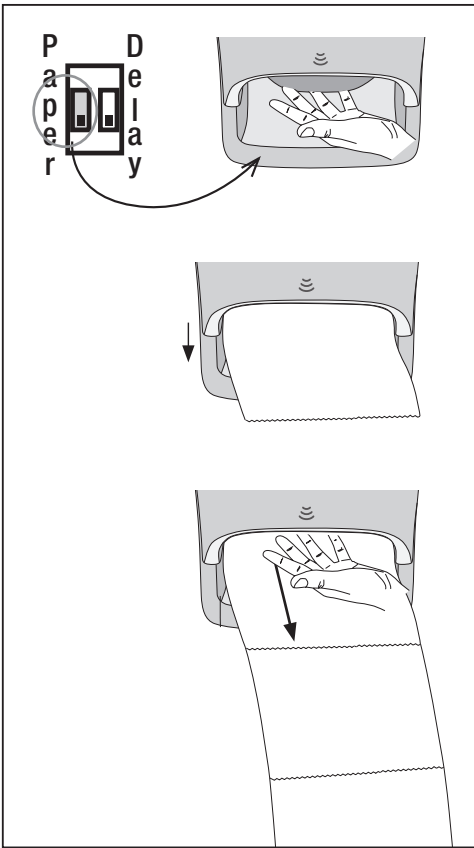
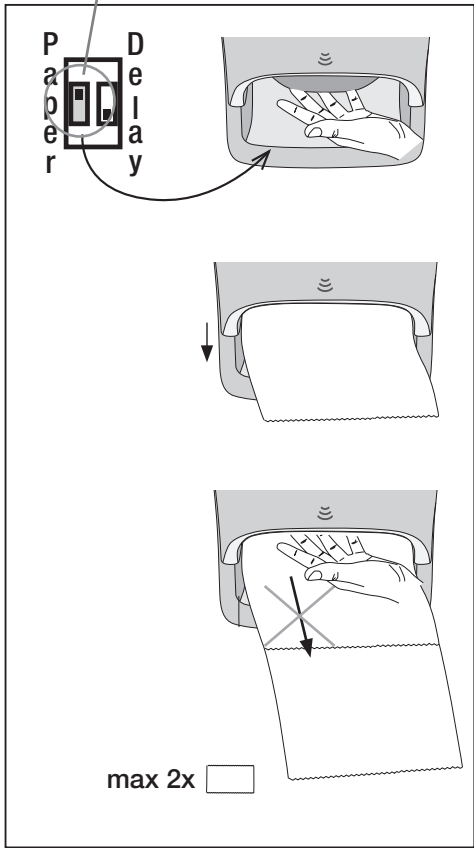
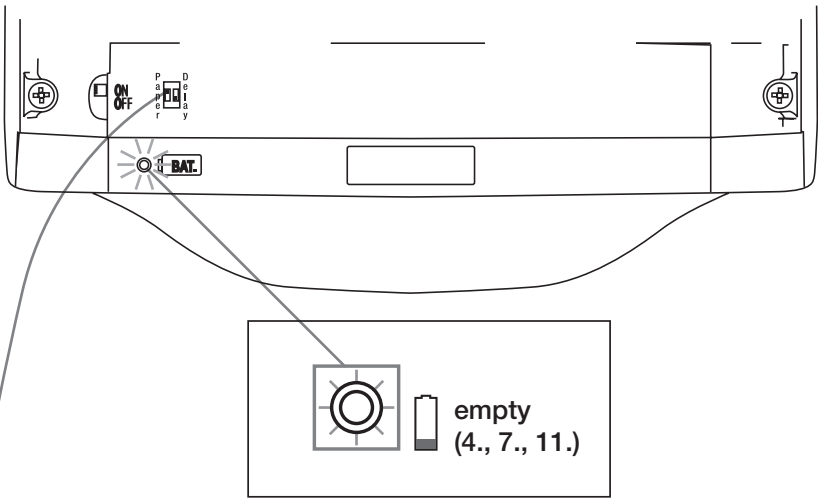

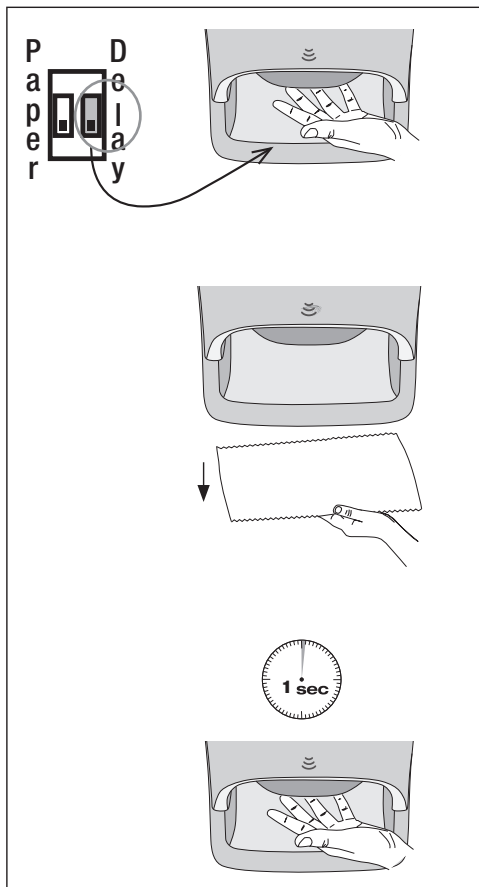
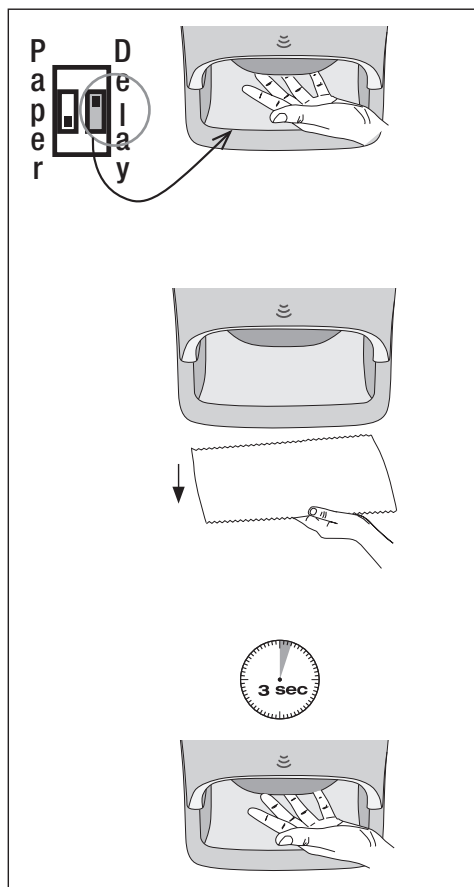

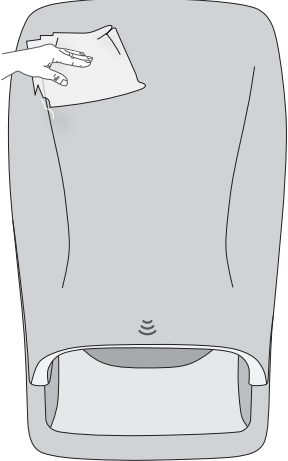



integralGLASS	Art.-Nr. 4410300319	✓
glasEFFEKT	Art.-Nr. 4450200708	✓
safetyWIPES	Art.-Nr. 4450300800	✓

# EC-DECLARATION of CONFORMITY

according to Directive 2006/42/EC on machinery

The distributor:

Company  
Hagleitner Hygiene International GmbH  
Lunastraße 5  
5700 Zell am See

declares under our sole responsibility that the entire system

inoxTOWEL		
Type: Dispenser	Mach. Nr.: P0253	Year of manufacture: 2013

Corresponds to the following regulations and standards:

**- European Directives regulations:**

2006/42/EC	Machinery directive
2006/95/EC	Low Voltage Directive
2004/108/EC	EC Electromagnetic Compatibility (EMC) directive

**- Harmonised standards:**

EN ISO 12100	Safety of machinery
EN IEC 60947	Low-voltage switchgear and control gear
EN CISPR 14-1	Electromagnetic compatibility - Requirements for household Appliances, electric tools and similar apparatus - Part 1: Emission

The technical documentation is complete. The associated instruction manuals in the languages German and English are enclosed.

Zell am See, 22.01.2013

  
Hans Georg Hagleitner  
Chief Executive Officer  
Hagleitner Hygiene International GmbH